

HOSCH Sprung Blade Scraper Type A1

Parts List (1/2)

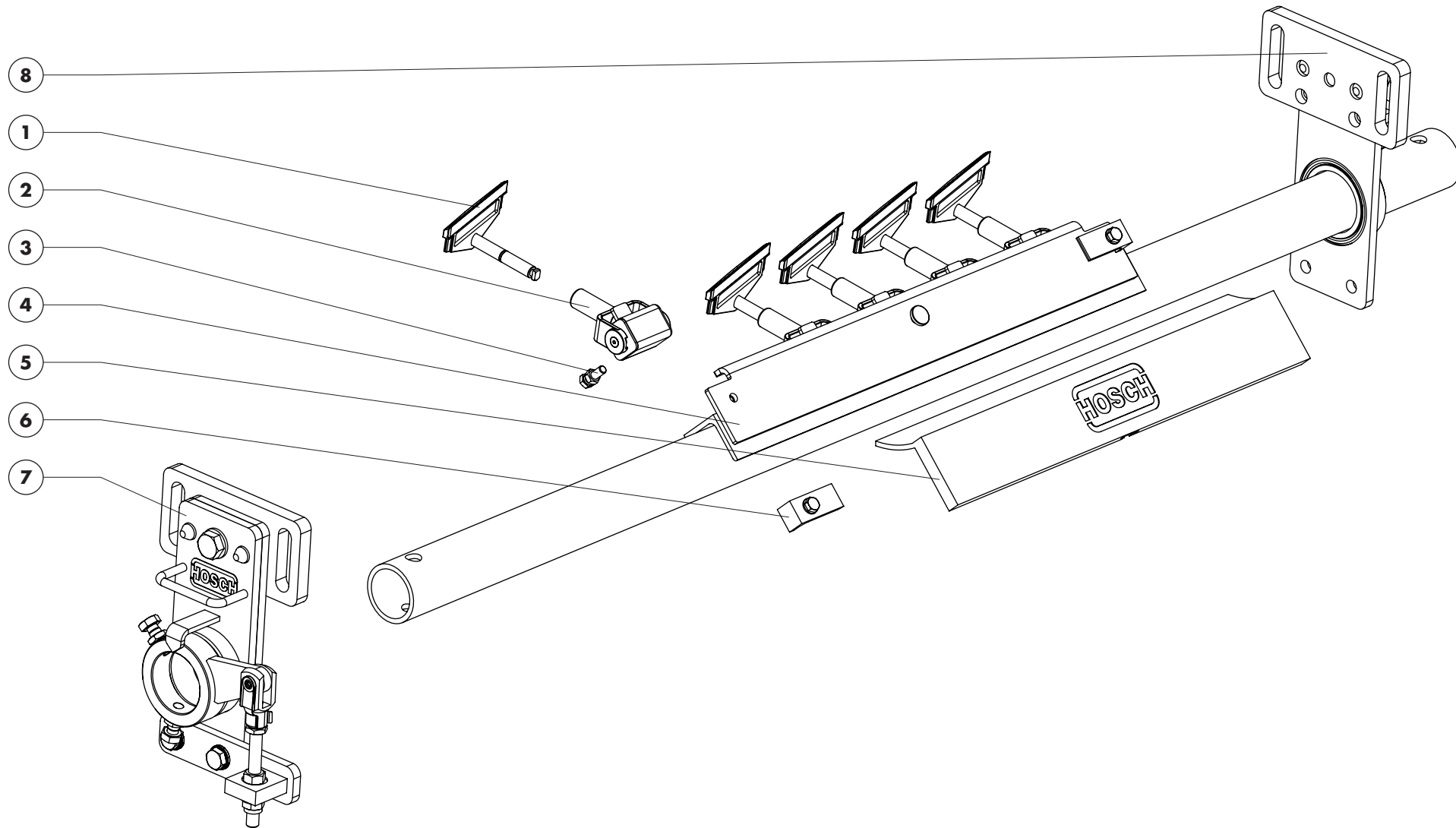

HOSCH Sprung Blade Scraper Type A1

Parts List (2/2)

Pos.	HOSCH ID	Description	Weight [kg]	Belt width [mm]						
				500	650	800	900	1000	1050	1200
1	0560601	Cleaning module A1, blade 15° X4-12N	0,32	4	5	6	7	8	9	10
2	0560610	Tensioning element A1	0,46	4	5	6	7	8	9	10
3	0560612	Fastenings for tensioning element A1	0,02	4	5	6	7	8	9	10
4	0560615	Assembly carrier A1 - 500/4, galvanized	12,7	1						
	0560620	Assembly carrier A1 - 650/5, galvanized	14,1		1					
	0560625	Assembly carrier A1 - 800/6, galvanized	16,2			1				
	0560630	Assembly carrier A1 - 900/7, galvanized	17,6				1			
	0560635	Assembly carrier A1 - 1000/8, galvanized	19,1					1		
	0560638	Assembly carrier A1 - 1050/9, galvanized	21,5						1	
	0560640	Assembly carrier A1 - 1200/10, galvanized	22,9							1
5	0560645	Wear protection plate A1 500	0,62	1						
	0560650	Wear protection plate A1 650	0,78		1					
	0560655	Wear protection plate A1 800	0,94			1				
	0560660	Wear protection plate A1 900	1,10				1			
	0560665	Wear protection plate A1 1000	1,26					1		
	0560668	Wear protection plate A1 1050	1,42						1	
	0560670	Wear protection plate A1 1200	1,58							1
6	0560673	Fastenings for wear protection plate	0,26	1						
7	0560675	Mounting with tensioning unit A1, right-hand version	6,90	optional*						
	0560680	Mounting with tensioning unit A1, left-hand version	6,90	1						
8	0560685	Mounting A1	3,80	1						
Total weight per scraper in standard execution [kg]				27,5	29,8	32,9	35,3	37,7	41,1	43,4

** Standard: left-hand version (see illustration on page 1). Upon request: right-hand version